

User Manual

Pocket Office

On behalf of the entire Ori team, I'd like to welcome you to the growing Ori family – we are so excited you've chosen to live with Ori, and given us the opportunity to be a part of your life. We started Ori to improve the lives of people by helping them make better use of their living spaces. We believe that these spaces should respond to our needs and adapt to our everyday lives. And in a world of rising real estate prices and shrinking living spaces, we want to help people live large in a smaller (and smarter) footprint. That vision guides us every day.

This User Manual will introduce you to your Ori, and show you how you can find everything you need to make the most of living with Ori. Please know that the entire Ori team is ready to help, so never hesitate to reach out. We want to help you live the life you want, where you want to live it – so let's get started!



Hasier Larrea

Founder & CEO

ceo@oriliving.com

we
welcome

Product Overview

01

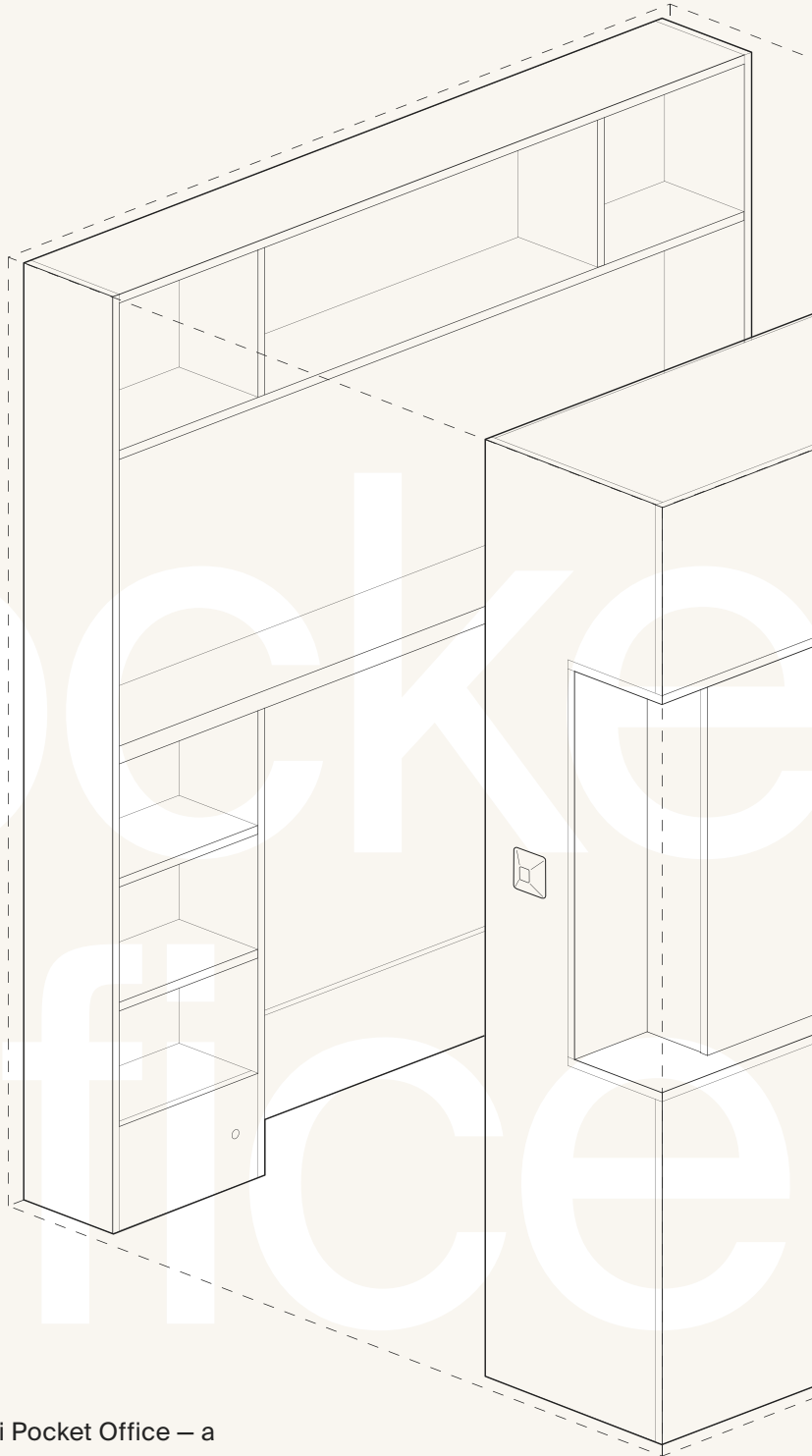

Make room for the work day with Ori Pocket Office – a flexible and functional home office setup that appears when it's needed and disappears at the end of the work day so you can disconnect and relax.

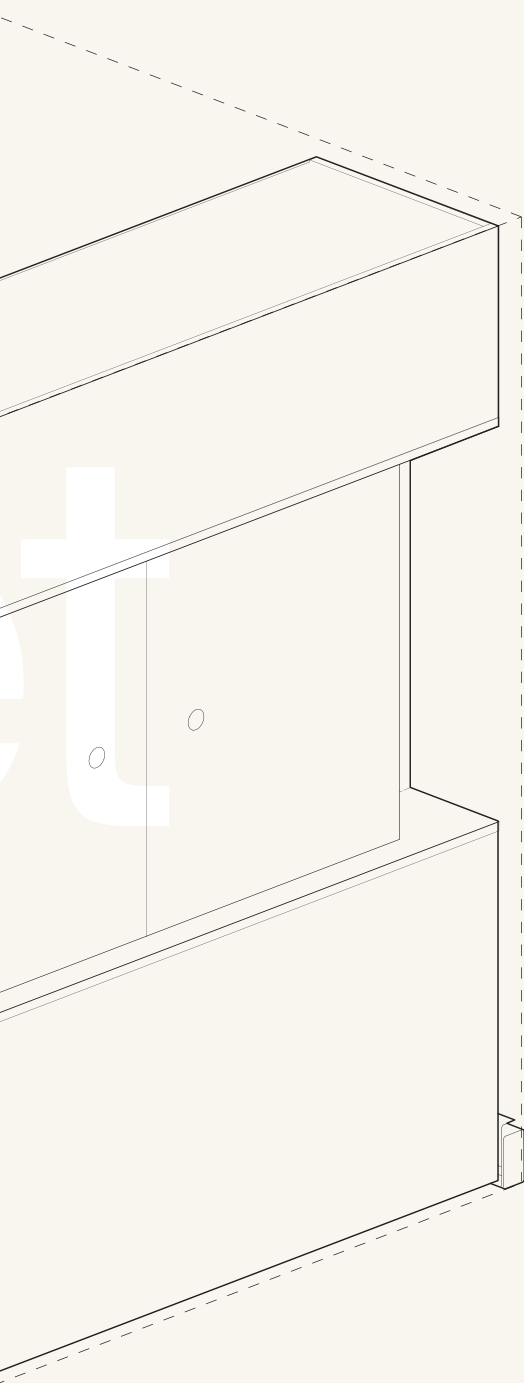

TRANSITION TIME

MAX MEDIA SIZE

20 sec

65" TV

HOME OFFICE

Be your most productive self. With space for 2 monitors, a chair, and copious storage, your dedicated home office appears when you want it and disappears when you don't.

VIDEO BACKDROP

The back of the Pocket Office is more than just a functional storage piece. It also doubles as a beautiful backdrop for video calls.

MEDIA CENTER

Showcase on the built-in display, with space for books, plants, treasures, and a 65" TV max.

ABUNDANCE OF STORAGE

Cut down on clutter with ample storage that keeps everything within arm's length.

LED LIGHTING

See exactly what you're doing, with built-in LED lighting that casts a warm yet effective glow onto your space.

The Ori Square

02

Effortless Transformation



ACTIVATE THE SQUARE

Tap the Ori logo to wake the Ori Square.
You will see various icons light up.



CREATE A ROOM

Tap the  icon on the bottom of the Square to hide or reveal your office.

ADJUST THE LIGHTS

Tap the  icon to turn Ori's lights on or off.
Tap  or  to adjust the brightness.

ADJUST SYSTEM POSITION

Press and hold the arrows   on either side to adjust the system's position as needed.



ORI SQUARE
TUTORIAL



Customization & Control

03

REMOTE CONTROL APP

Download Ori App

Use the QR codes below to download the app to your phone.



Create Your Ori Account

Click “sign up” on the home screen to create your Ori account.

Connect Your System to WiFi

Follow on-screen instructions to connect to your system via WiFi.

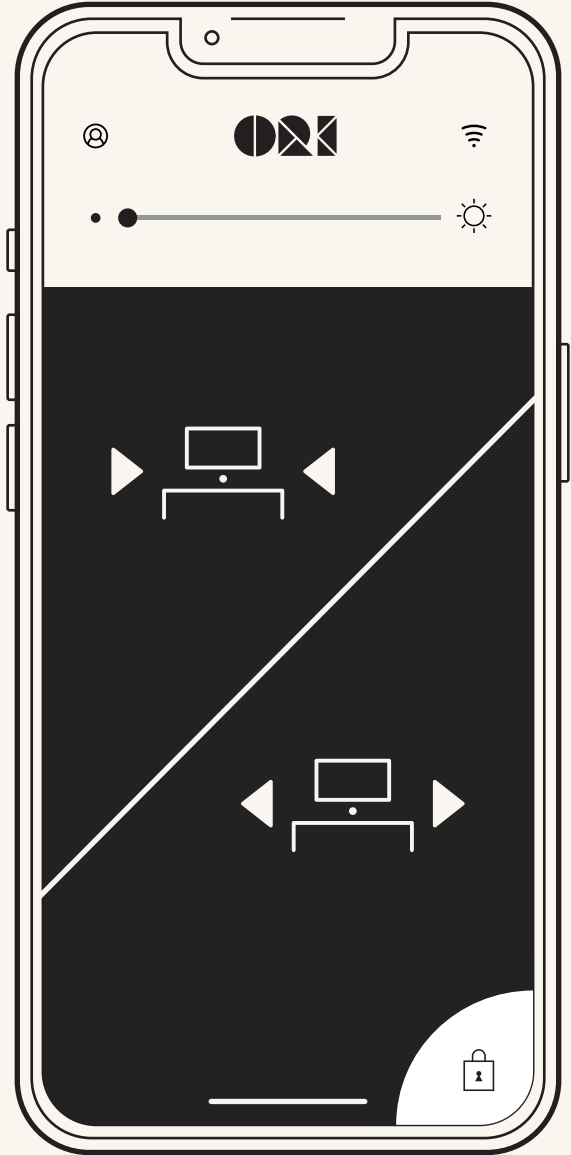
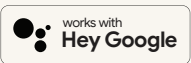

USER PORTAL

Ori's User Portal is a one-stop-shop, helping you complete your Ori setup with voice control and lock mode, routing you to our Service Portal, and giving you the opportunity to provide feedback and earn cash.

Visit user.oriliving.com for more.



USER PORTAL

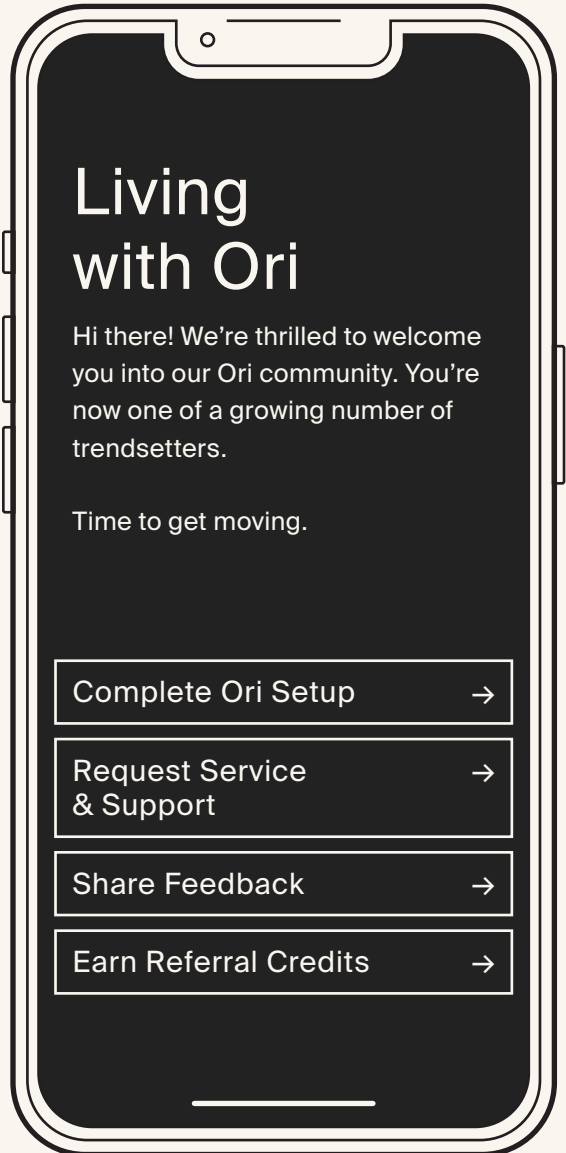

Troubleshooting & Support

04

Need help?

Ori systems are tested rigorously, so we don't expect any problems. In the unlikely event of one, our Service Portal gets you help fast. From movement issues to damage, we've got you covered.

Visit service.oriliving.com
for more.



SERVICE PORTAL

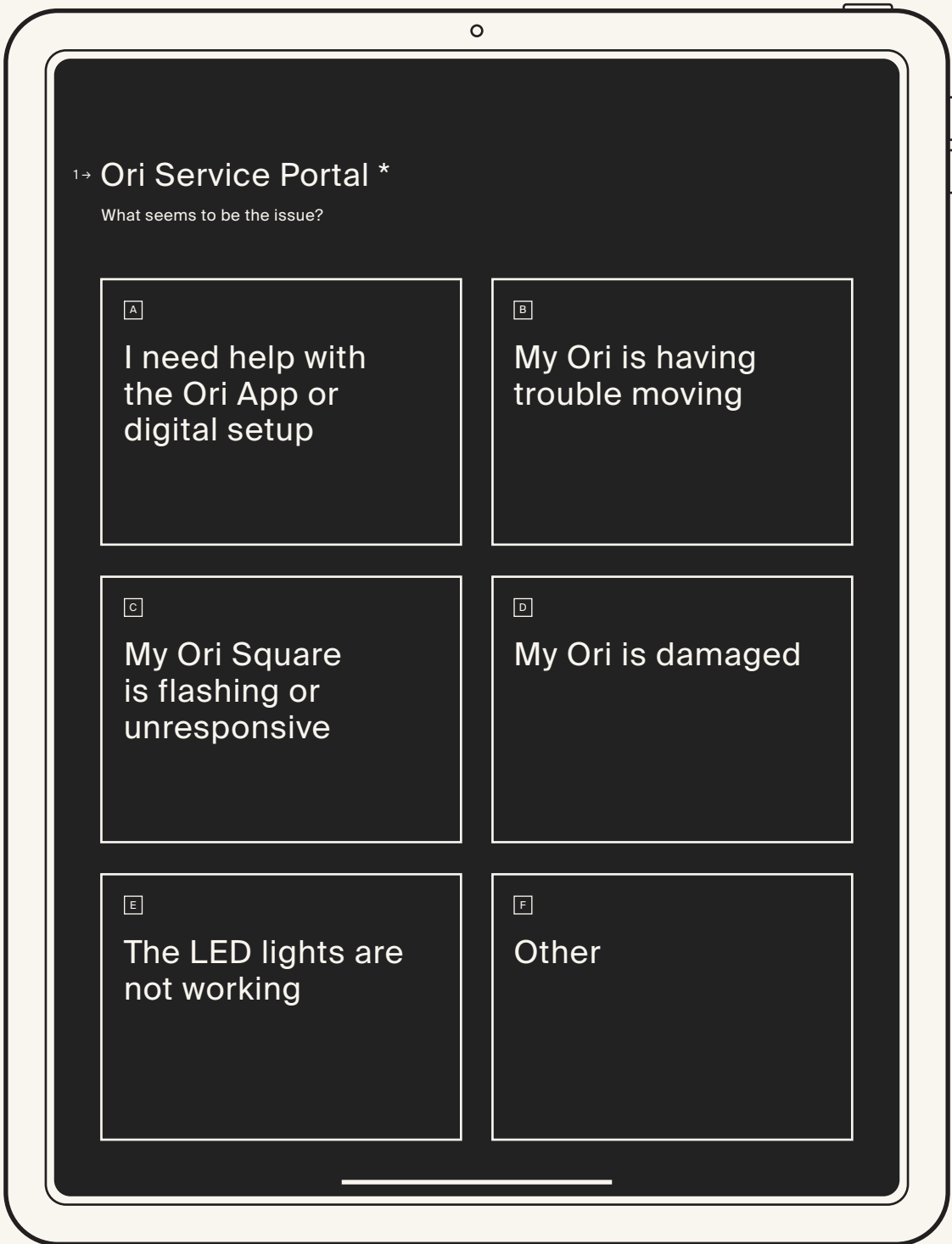

1→ Ori Service Portal *

What seems to be the issue?

A

I need help with the Ori App or digital setup

B

My Ori is having trouble moving

C

My Ori Square is flashing or unresponsive

D

My Ori is damaged

E

The LED lights are not working

F

Other

User Tips & Tricks

05

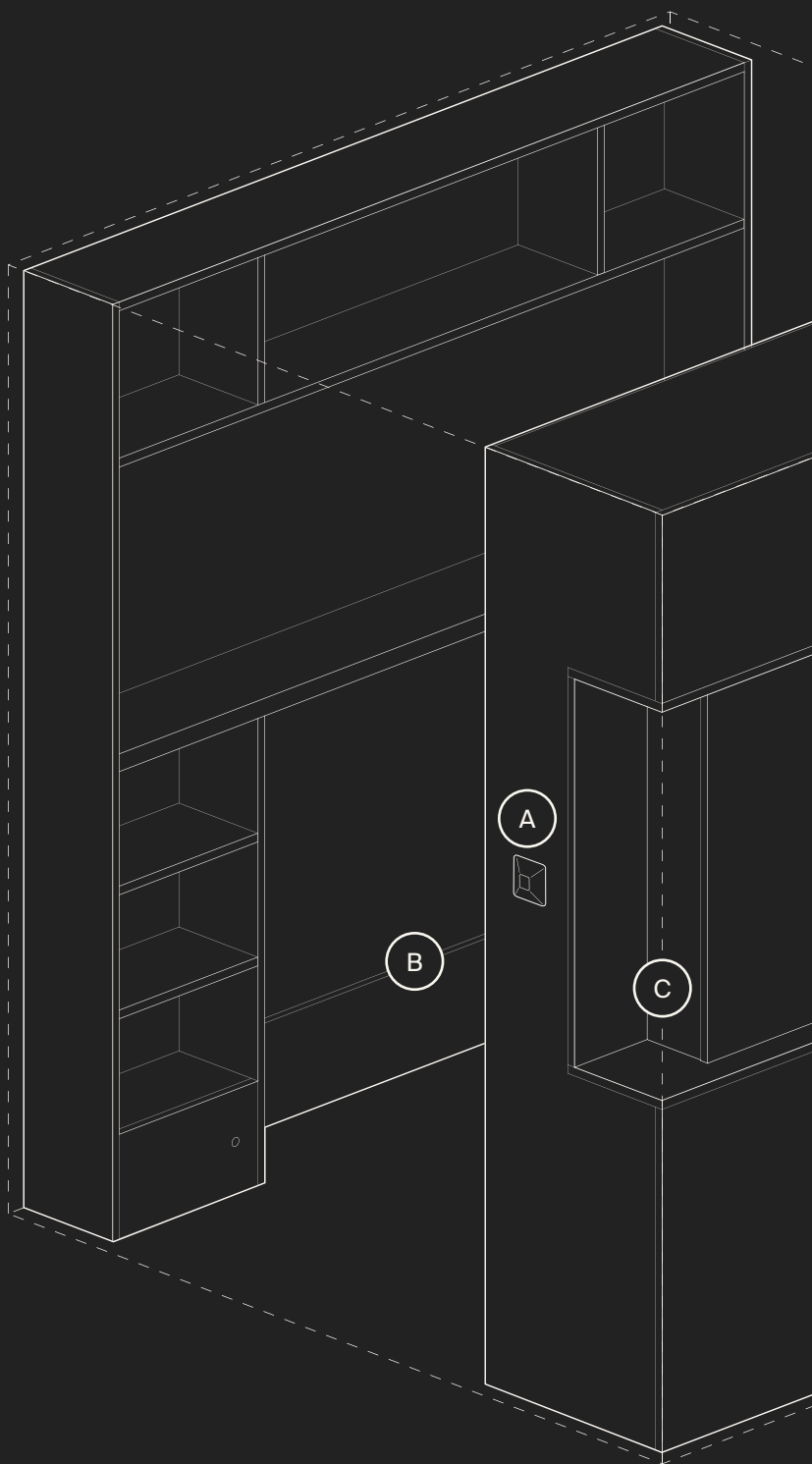

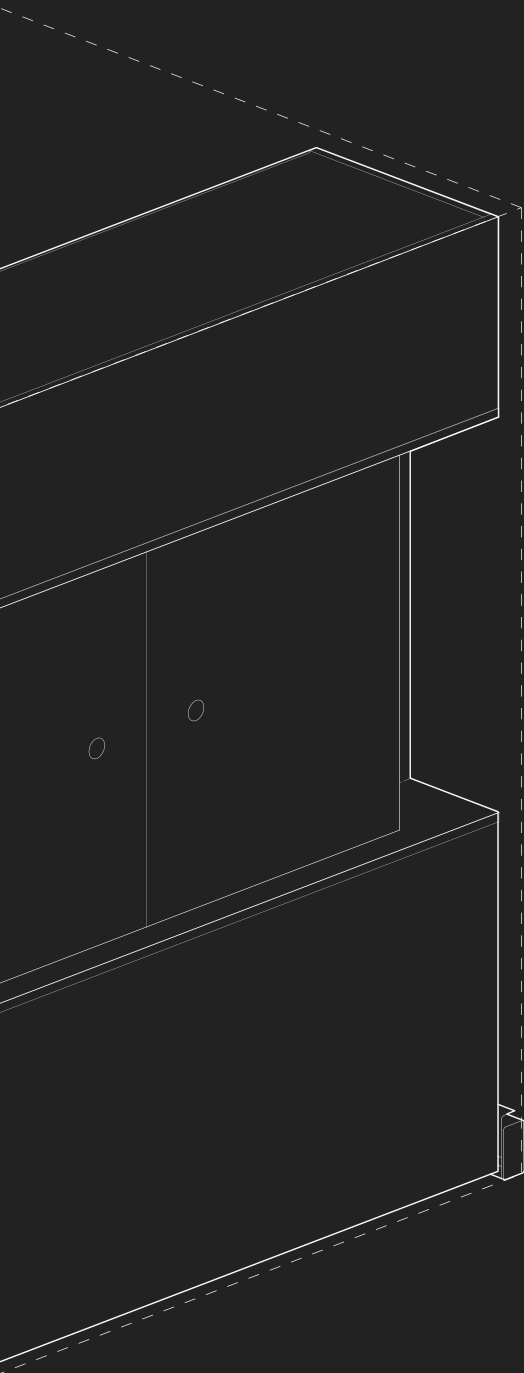

A. ADJUSTING PRESET POSITIONS

The Ori Pocket Office's preset positions can be adjusted or reset if necessary (for example, upon move-in or after a power outage). Please visit the Ori Service Portal for guidance.

B. USING YOUR OFFICE CHAIR

The Ori Pocket Office can accommodate an office chair inside the unit when it is closed. To keep the chair inside the system when it is closed, ensure the chair is centered along the back portion. The chair must have a maximum height-width-depth ratio of 40" x 42" x 24". Arm rests must be a maximum of 27" high. For Pocket Office units without the back, static element, the office chair has to be removed when the system is closed.

C. MOVEMENT IN A POWER OUTAGE

If the power ever goes out, fear not. You can easily move your Pocket Office manually. It may be helpful to grab a shelf or the cable grommet when pulling the system.

If you ever need to move your system manually for a different reason, just make sure to unplug it first. Doing so disengages the motor and enables manual movement.

Safety

06

MAX LOADS/ POCKET OFFICE LARGE

System Max: 450 lbs.

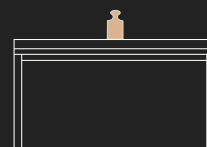
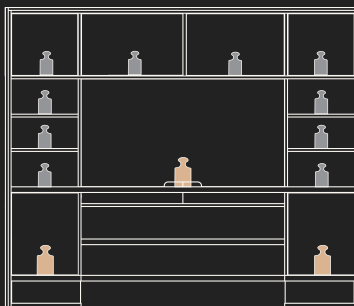
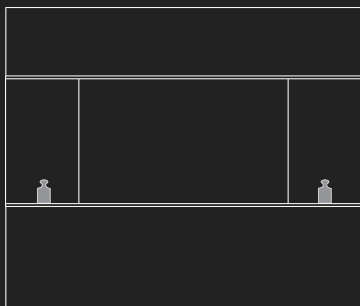

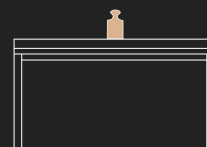
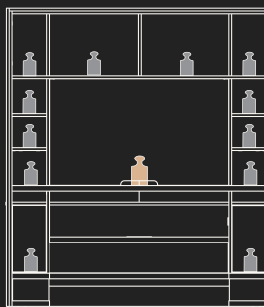
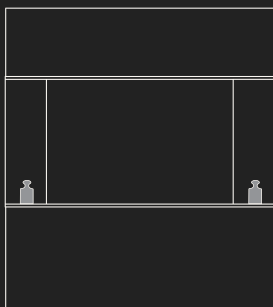

MAX LOADS/ POCKET OFFICE MEDIUM

System Max: 400 lbs.



KEY

50 lbs. 

25 lbs. 

10 lbs. 

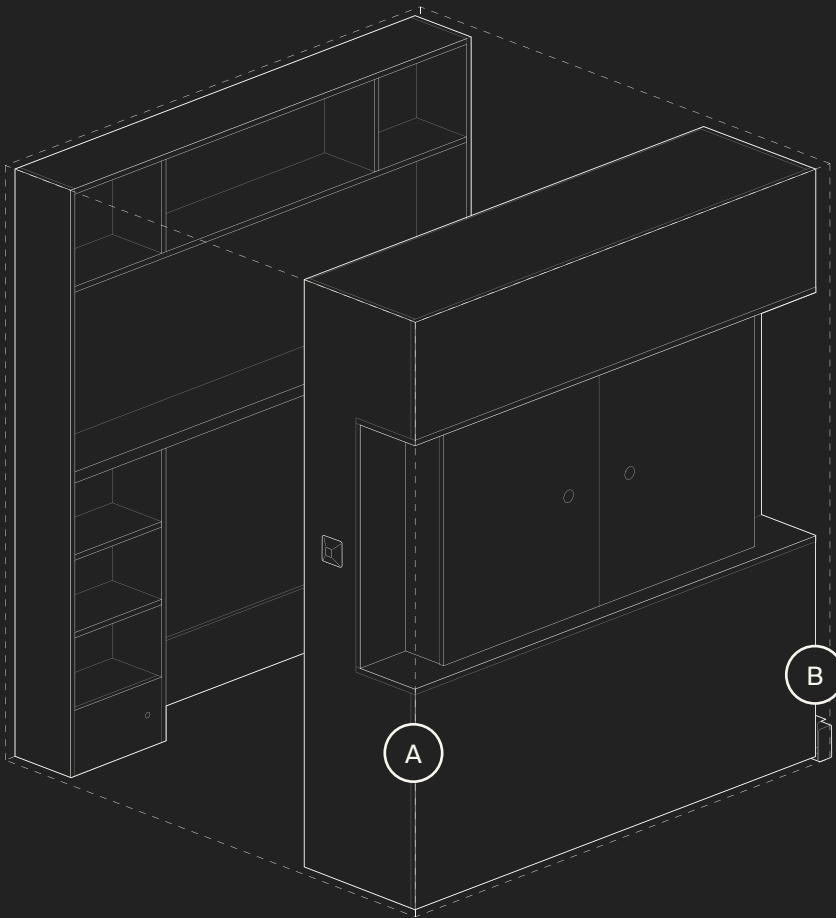

A. SAFETY-STOP

Ori comes equipped with an auto-stop feature, which automatically halts and retracts the system when it encounters an obstacle, such as a person, pet, or object. All it takes is the force of two fingers to halt any movement.

B. OVER CURRENT PROTECTION

If too many devices that are plugged into the Pocket Office's outlets are in use at the same time, the system's over current protection will trigger, cutting the power. If this occurs, switch off all the plugged-in devices, reset the power by pressing the red button at the end of the guidance track, and then resume use of a fewer number of devices.

- Input Voltage: 125Vac
- Input Frequency: 50/60 Hz
- Operating Power; moving: 40W
- Max Power; lights: 60W
- Max Power per power strip: 1320W
- Max Linear Speed: 4inch/s = 100mm/s

Do NOT plug vacuum cleaners or hair dryers into any outlet on your Ori system.

Safety Notices

Household/Residential Use Only - only operate on hard surfaces. Read all instructions before using the Pocket Office. When using an electrical furnishing, basic precautions should always be followed, including the following:

DANGER - To reduce the risk of electric shock: Always unplug this furnishing from the electrical outlet before cleaning.

DANGER - Do not operate the bed unless you know that no child or pet is on the bed. Serious injury or death could result from a child or pet being left on a raised bed for an extended period of time.

WARNING - To reduce the risk of fire, electric shock, or injury to persons:

1. Unplug from the outlet before putting on or taking off parts.
2. Close supervision is necessary when this furnishing is used by, or near children, invalids, disabled persons, or pets.
3. Use this furnishing only for its intended use as described in these instructions. Do not use attachments not recommended by the manufacturer.
4. Never operate this furnishing if it has a damaged cord or plug, if it is not working properly, if it has been dropped or damaged, or come into contact with water. Contact Ori Support for examination and repair.
5. Keep the cord away from heated surfaces.
6. Never operate the furnishing with the air openings blocked. Keep the air openings free of lint, hair, and the like.
7. Never drop or insert any object into any opening.
8. Do not use outdoors.
9. Do not operate where aerosol (spray) products are being used or where oxygen is being administered.
10. To disconnect, remove plug from outlet.

WARNING - Risk of death or

serious injury may occur when children climb on audio and/or video equipment furniture. A remote control or toys placed on the furnishing may encourage a child to climb on the furnishing and as a result the furnishing may tip over on to the child.

WARNING - Risk of death or serious injury may occur due to the furnishing collapsing or over turning onto a child when relocating audio and/ or video equipment to furniture not specifically designed to support audio and/or video equipment.

WARNING - Risk of Electric Shock - Connect this furnishing to a properly grounded outlet only. See grounding instructions.

WARNING - If the unit is installed within 6' of a sink, it must be plugged to a branch circuit provided with Class A GFCI protection.

GROUNDING INSTRUCTIONS

This product is for use on a nominal 120-volt circuit and has a grounding plug that looks like the plug illustrated in sketch A (see next Figure). Make sure that the product is connected to an outlet having the same configuration as the plug. No adapter should be used with this product.

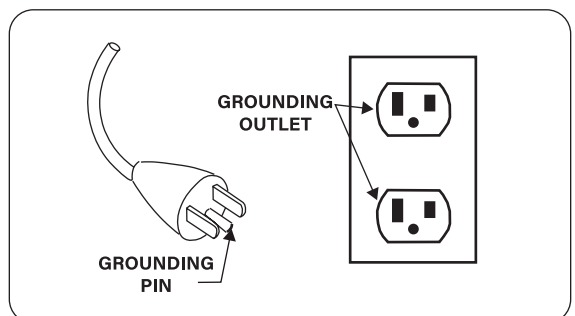

SAVE THESE INSTRUCTIONS



DOC-PLT-0103-001 Rev A
Ori, Inc.
12 Channel St, Suite 202
Boston, MA 02210
www.oriliving.com